

TECH NEWS

#10/18

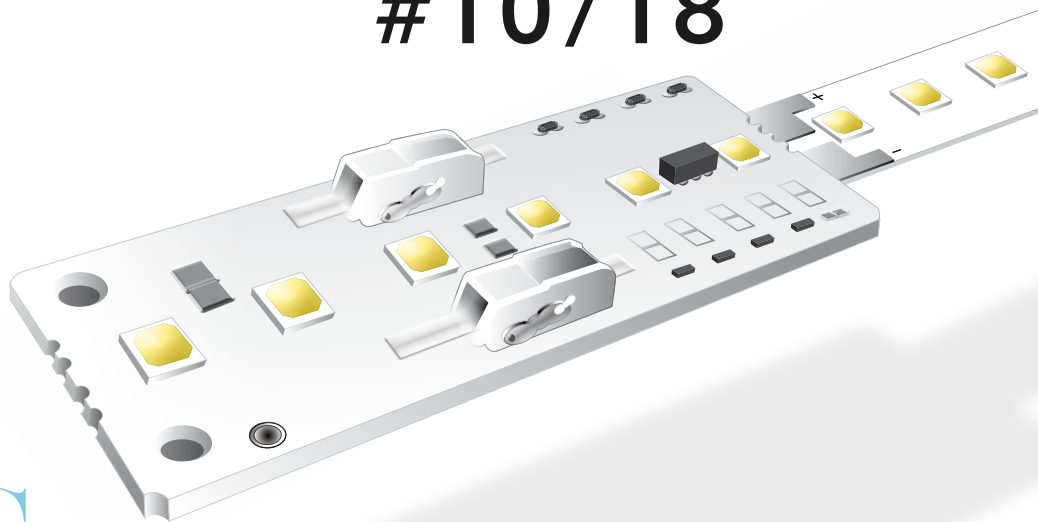

INTEGRATED ELECTRONICS

Forward thinking

BILTON INNOVATION 2018

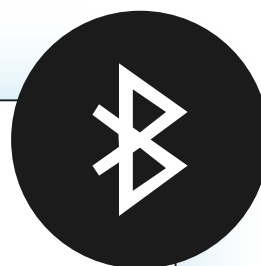

**BILTON
SMART CORE X-LINE**

BILTON

www.biltongroup.com

ENHANCE YOUR LED STRIP

WE ARE CONVINCED THAT THE AGE OF LED LIGHTING IS STILL IN ITS INFANCY. WE ARE CONSTANTLY WORKING ON NEW PRODUCTS TO MAKE LED LIGHTING EVEN MORE INTELLIGENT AND INTUITIVE.

ELE SMART CTRO CORE NICS

APPLICATIONS

- / The BILTON X-LINE Smart Core luminaire with Bluetooth function can be installed in any project and end product.

ADVANTAGES

- / Control via Bluetooth device
- / High cable lengths possible due to central supply
- / No more soldering of cables necessary thanks to integrated spring terminals
- / Space- and time-saving

LED luminaire with integrated BILTON Smart Core

With **BILTON X-LINE SMART CORE**, BILTON is launching a series of ultra-modern lighting components that make our configured luminaires of the BILTON X-LINE series almost limitlessly smart. Thanks to the strain-relieving end feed, technically induced dark zones are a thing of the past. A centre feed into the LED strip can also be realised so that very long cable lengths can be designed. The integrated spring-loaded terminal allows the connection cable to be easily connected to the circuit board without any soldering. Fast, simple, and safe!

Due to the integrated radio module and standardized **BLUETOOTH** protocol, the BILTON X-LINE series is equipped with the ability to be easily and individually controlled.

All in all a smart extension of the BILTON X-LINE series.

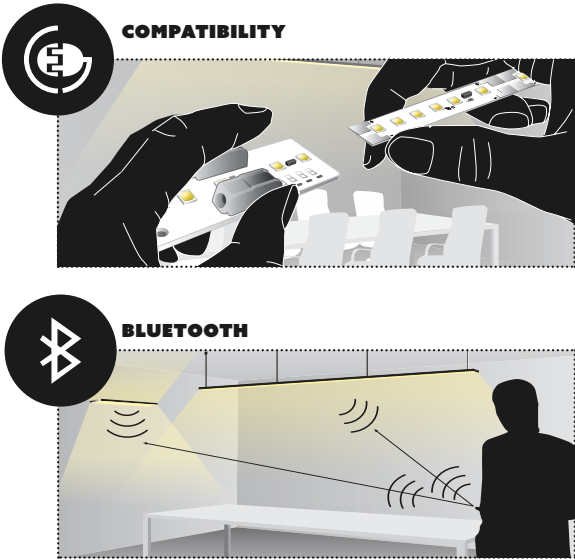

DEVELOPMENT PHASES

With its patented Smart Core, BILTON is developing the intelligent LED light of the future. This not only makes the LED light Bluetooth-capable, but also eliminates the need for external control - in addition to avoiding dark spots. In order to fully develop the product, it was created in three steps:

STEP 1

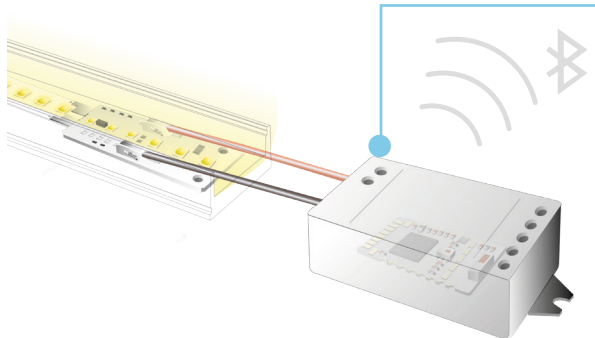

SMART-CORE CONTROLLED BY CONTROL UNIT

The BILTON Smart Core was developed, among other things, to avoid dark spots in LED lighting in the future. The LED chips are attached to the end of the Smart Core board.

In the second step, the intelligence of the controller is to be integrated into the LED light - so in future no intelligence from outside will be necessary.

The controller contains the circuit board that BILTON uses for further development.

STEP 2

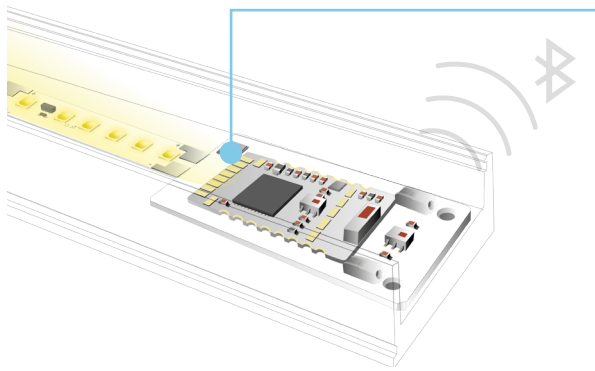

BOARD BUILT INTO THE LUMINAIRE

In order not to have to use an external controller in the future, the controller is integrated into the profile and soldered to the BILTON LED module. The radio module is integrated in the control to make the LED lighting Bluetooth compatible. In addition, there are spring-loaded terminals at the front of the board so that the cables for the power supply unit can be easily connected.

With its dimensions of (W x L) 17.3 and 50.0 mm, the board is small, but nevertheless visible in the luminaire as a dark spot

STEP 3

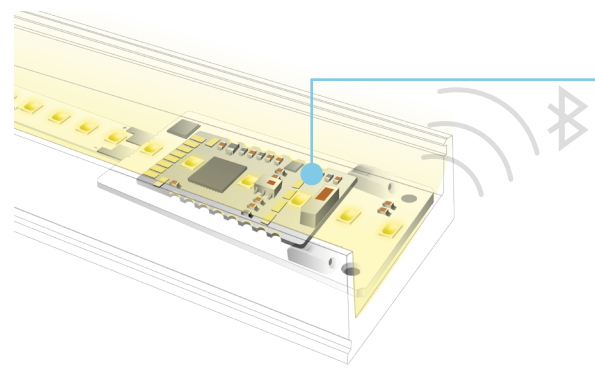

BOARD INTEGRATED WITH LED-CHIPS FOR COMPLETE ILLUMINATION OF THE LUMINAIRE

The combination of board and BILTON Smart Core enables the perfect simultaneous use of electronics and avoidance of dark spots. LED chips are additionally attached and connected to the circuit board so that the luminaire can show its full luminosity right through to each end.

And of course all this in combination with the Bluetooth control.

The results speaks for themselves: The first continuously illuminated LED lighting with integrated intelligence.

DESIGNING FUTURE

**BILTON IS THE SPECIALIST WITH
IMMENSE EXPERTISE IN
LINEAR LIGHTING.
IT IS BILTON'S DECLARED
OBJECTIVE TO ESTABLISH A
NEW DIMENSION OF LIGHTING
WITH LEDS IN ALL AREAS OF
LIFE, WHEREVER POSSIBLE.**

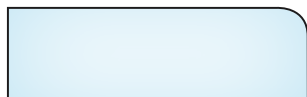
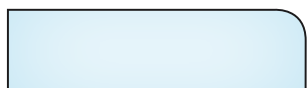

BILTON INTERNATIONAL GMBH

Lofererstraße 23
5760 Saalfelden, Austria
Tel.: +43 6582 71164
Fax: +43 6582 71164-999
www.biltongroup.com